



NEW PINION SEAL INSTALLATION TOOLS RELEASED FOR ADVANTEK40 MODELS

PART NUMBER INFORMATION

DATE: 5/28/2016

TO: All Dana Aftermarket Group Spicer® Service Parts Heavy Axle Customers

Affected Models: All D155, R155, D156, R156 Tandem Drive Axles

Dana is pleased to announce the release of the pinion oil seal driver installation tool kits for the AdvanTEK-40 models listed above. Kits 504300 and 504325 are now in stock and available to order.

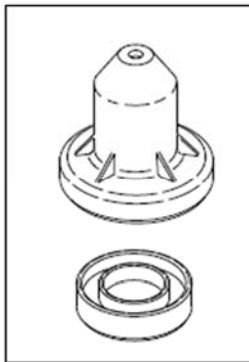

OIL SEAL DRIVER INSTALLATION KIT CONTENTS					
504300			504325		
MODELS: D155 / R155			MODELS: D156 / R156		
Part-No.	Description	Use w/ Seal #	Part-No.	Description	Use w/ Seal #
126917	DRIVER		126917	DRIVER	
10021492	INSERT	134583	10021492	INSERT	134583
10021495	INSERT	2023063	10021493	INSERT	2019185
			10021494	INSERT	2022740

When replacing and reinstalling any pinion seal it is always recommended that the proper installation tools be used to insure a proper fit. Additional information and instructions can be found in **SHAIS157D** (Pinion Seal Installation Tools and Installation Instructions) available in the Literature Library at www.spicerparts.com.

As always, your continued support of Genuine Spicer® products is appreciated!

Bernie Powers
Product Manager

Spicer® Heavy Axle Products

HD AXLE INFO